

'George Squared' - a work for discussion.

shown as: individual interpretations.

a composite with comments about production.

combined in a very graphic m

① "Graphic 'minimal version'" **RED** | caption STRIKE! 1919 - | shot of George Sq. different camera | Reform Photo Red Flag

② **STRIKE!** 1919 | Documentary version: would also include "archive angles - caption footage" of George Sq etc... | George Sq. / Artists with cameras? / Artists in 1990! | B+W figures, different locations around the sq, looking away, gestures of defiance. | Artists with cameras different positions **1990** | Reform Photo Red Flag

**THREAT** | Threat at Reform Photo figures

③ "Epic Theatre" | A tribute to the work of Sergei M. Eisenstein | **BLACK & WHITE RED FLAG** | **STRIKE!** 1919 | A restaging of the raising of the Red flag in George Sq - B+W - Hand or raised flag

④ "State of the Art" version: | **RED** | combining graphic techniques etc - where history meets the technology | montage techniques, cut of km etc | constructed thru the use of the techniques etc

GEORGE SQUARED: Respectfully dedicated to the people of Glasgow.  
Each interruption: would begin & end in the color "red"

in main style

captain  
Glasgow  
1990



30 seconds

could include faces  
more of the people of  
Glasgow

individuals  
causing the  
problems, fists  
clenched  
etc

1990

magazine  
"TMTSS"

ARTISTS:  
TMTSS

Glasgow  
1990



1 min.  
- talking to people of  
Glasgow -

Punctuate the present with the  
in B+N against clear background

use "Classic"  
montage  
techniques

cast of 200-300 people.

snapping, moving camera  
movements & 10 second (pic)

could also  
include  
archive footage?  
into the rest of the  
film.

Glasgow  
1990  
EMPTY SCENE  
GEORGE SQ.

shoot individuals  
in scene against  
background, combine  
them together since  
with with and  
getting.

Glasgow  
1990



1 1/2 mins.



from top of the  
cym chamber



cut as  
mechanical  
around  
the square

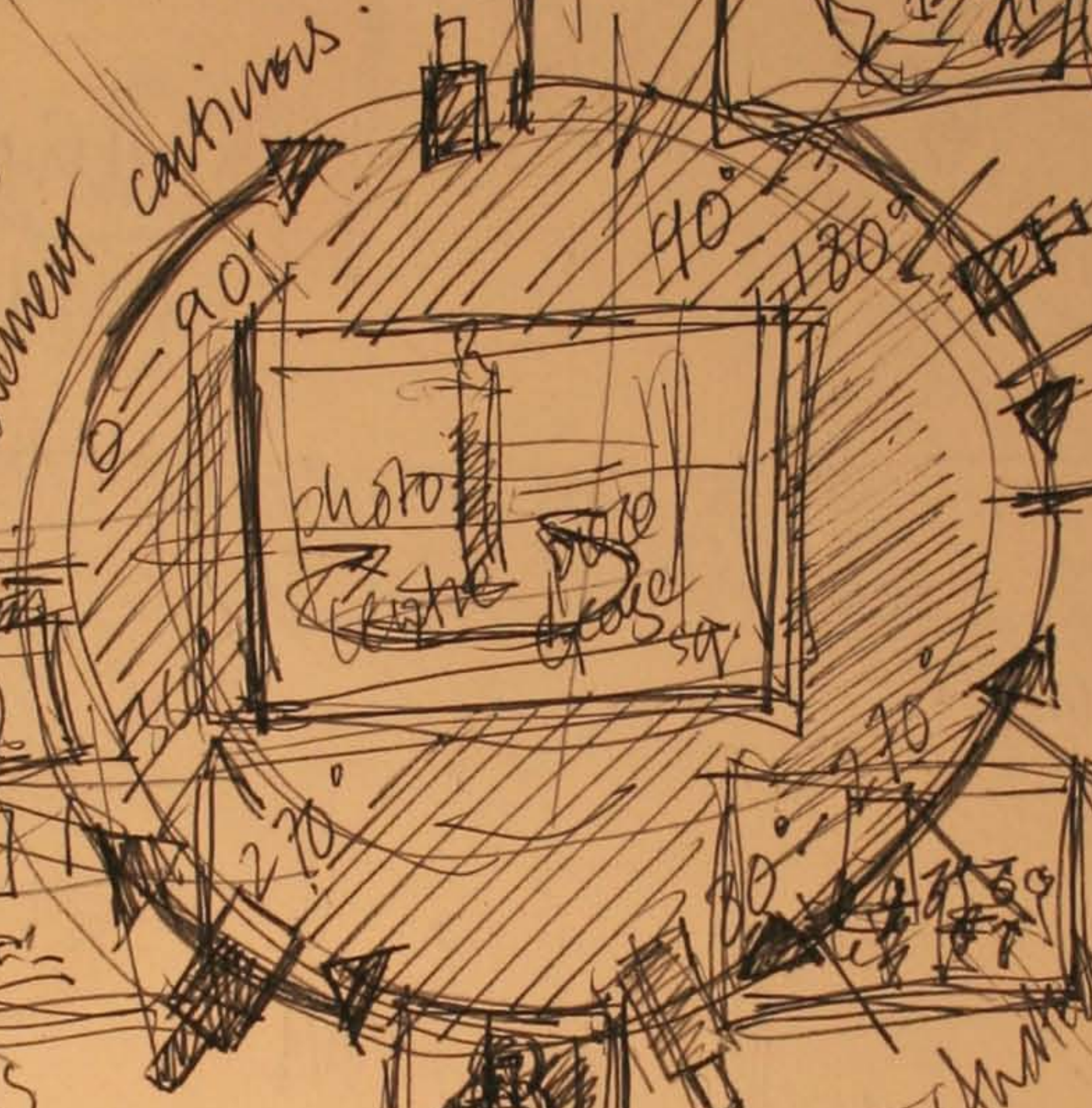

Direct stage  
cut away from  
moment  
continuous



cutting  
problems,  
transitions

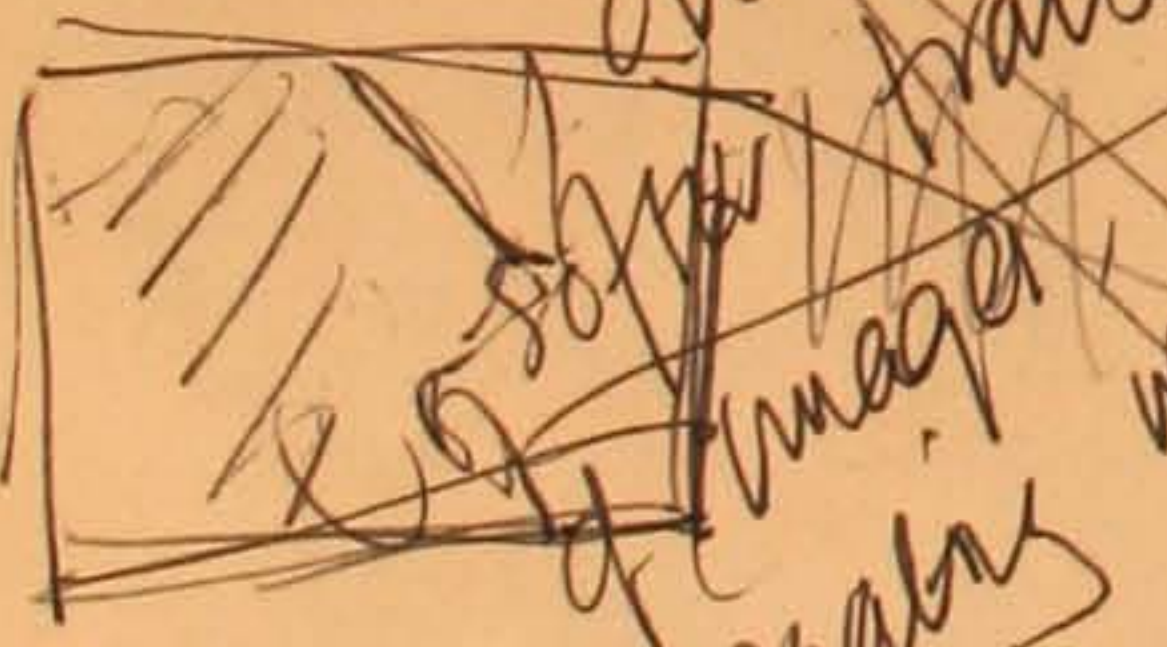

incorporating  
+ draw



achieved  
with  
rest of film



B.B.C  
images from  
Russia  
and USSR  
into square

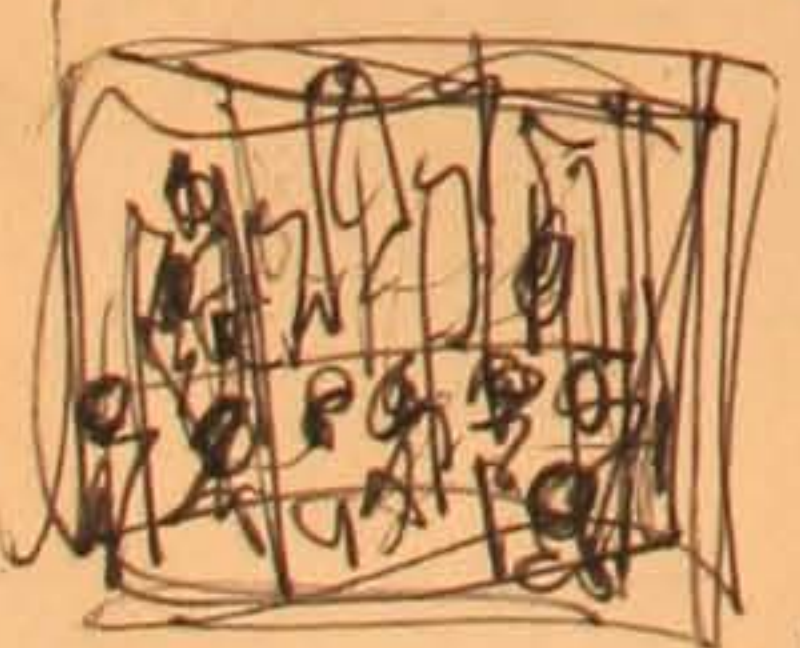

montage, cut to  
Red.



Black, White + Red?

Color Inserts?

Cuts to  
Red?

Grage Square (1919-1990)